

FORT WORTH MUSEUM OF SCIENCE AND HISTORY

2024 - 2025 Field Trip Chaperone Guide

Who's in my Group? List students here:

What's our Itinerary? Details here:

Official bus drop-off and pick-up is at 1600 Gendy St, Fort Worth, Texas 76107

Directions:

From I-30 head North on Montgomery Street. The Museum is located inside the Cultural District and will be on your right hand side after Dickies Arena. You may enter the Cultural District through either the intersection of Montgomery and Harley Ave or Montgomery Street and W Lancaster Ave.

Parking:

Personal vehicles may park in any lot inside the Cultural District (see map), however the City of Fort Worth will charge all vehicles \$12.00+. The Fort Worth Museum of Science and History does not control, monitor or staff any of the lots in the surrounding area.

Student arrival:

Buses will drop off students in the circular drive on Gendy Street. While educators may enter the building as early as 9:30 AM to complete check-in, the Museum will not open its doors to students, chaperones, adults, or the general public until 10:00 AM, rain or shine.

Admission:

- Adults who prepaid through their school ahead of time are welcome to wait outside the Museum with their students. They will receive proof of admission from the Lead Educator after check-in is complete.
- Adults who need to purchase admission on their own are welcome to do so either in advance online through our website or the day of the field trip with any cashier at 10:00 AM. Anyone purchasing individual admission will be charged at full price. Group Rates are not available at the door.

Lunches:

- The Museum does not have any available storage space, nor is any outside food or drink allowed inside any of the exhibit halls.
- We recommend leaving all lunches, coolers, backpacks and wagons in your vehicle both before & after lunch.
- All lunches will be held outside picnic style on the front lawn.
- The Exhibit Café and Heritage Courtyard are off limits to groups with sack lunches.

Museum Etiquette

Your role as a chaperone is crucial for an extraordinary learning experience. To ensure this, we ask that all groups do the following:

- Be attentive to your students at all times and make sure their enjoyment is not infringing on the enjoyment of others.
 - Students should maintain their best classroom behavior while in the museum and theaters.
 - Do not allow students to engage in roughhousing, climbing, or running. The safety of all our museum guests is important.
- Chaperones are required to remain with students of ALL ages at ALL times. Chaperones are responsible for student conduct.
 - Please refrain from prolonged usage of any personal electronic devices during your visit as it limits your ability to engage with your students.
 - Be curious and engaged! Participate in activities and ask questions. Your students will appreciate your attention.

FORT WORTH MUSEUM OF SCIENCE AND HISTORY

2024 - 2025 Parking Guide

Adult Parking Map

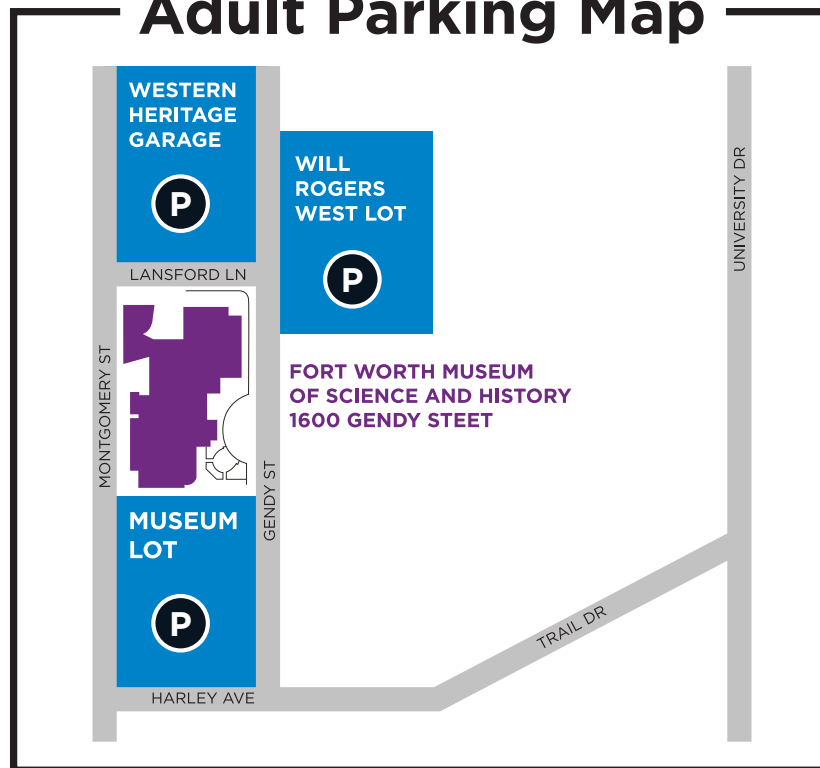

Student Drop-Off & Lunch Map

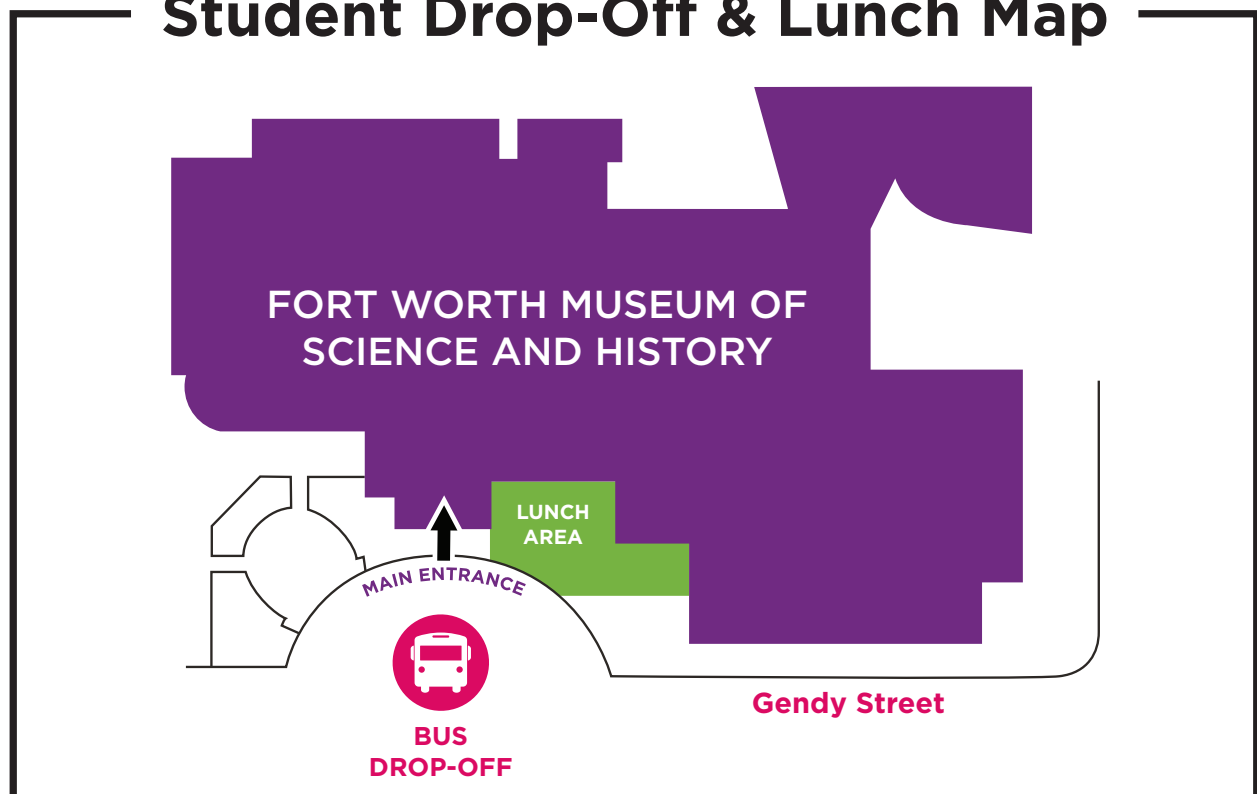

FORT WORTH MUSEUM OF SCIENCE AND HISTORY

2024 - 2025 Museum Map

FIRST FLOOR

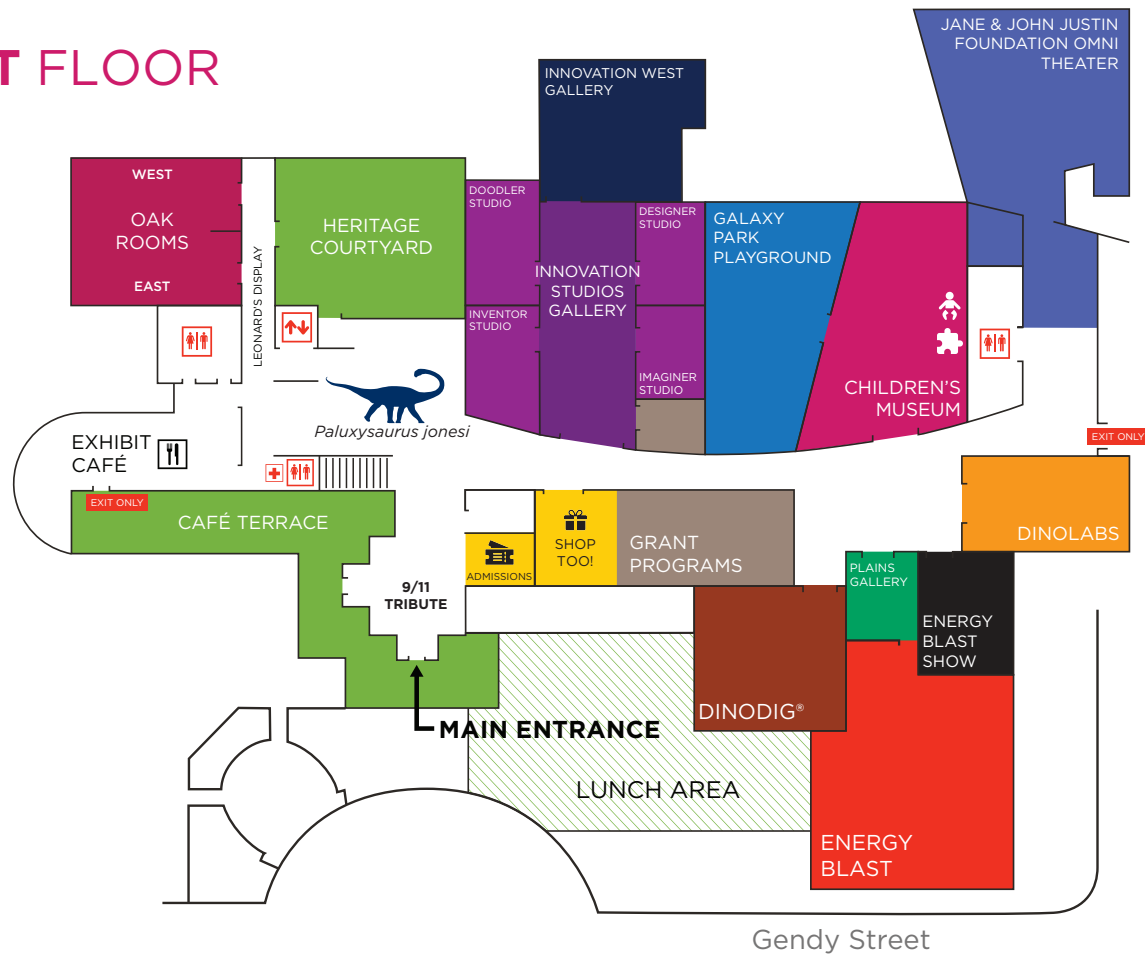

SECOND FLOOR

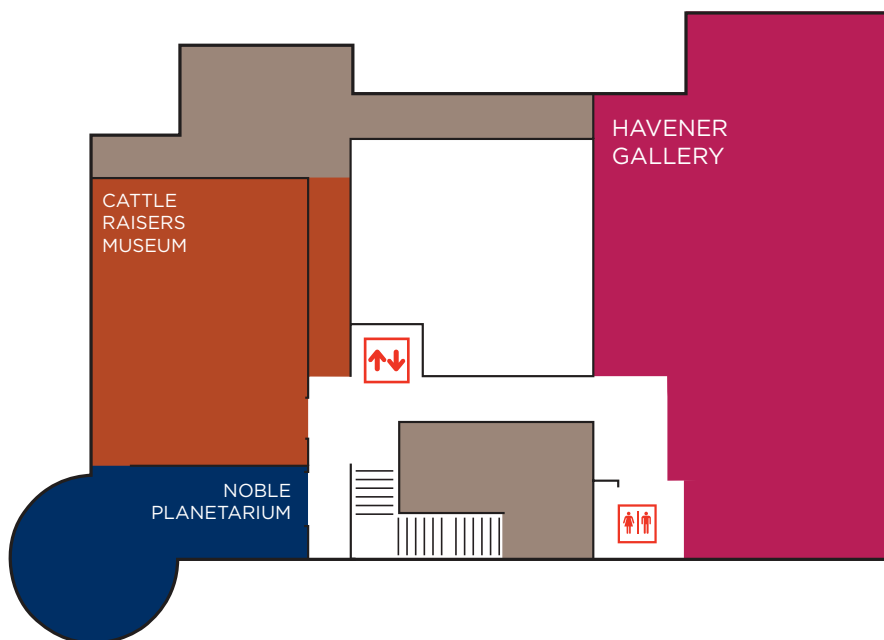

EXHIBIT CHECKLIST

FIRST FLOOR

- ☐ *Paluxysaurus jonesi*
- ☐ Leonard's Display
- ☐ Innovation Studios Gallery
- ☐ Innovation West Gallery*
- ☐ DinoDig®
- ☐ DinoLabs
- ☐ Children's Museum
- ☐ Galaxy Park Playground
- ☐ Plains Gallery
- ☐ Energy Blast

SECOND FLOOR

- ☐ Noble Planetarium
- ☐ Cattle Raisers Museum
- ☐ Havener Gallery*

*Travelling Exhibit Gallery